

主轴拉力计



RFS-BT40



RFS-HSK63A

- 油压机械结构, 稳定性高
- 用于刀柄锁紧装置拉力的检测

单位:mm

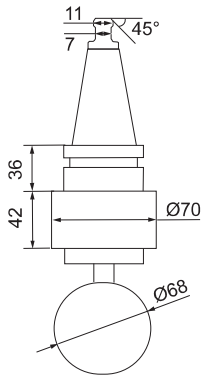

RFS-BT30

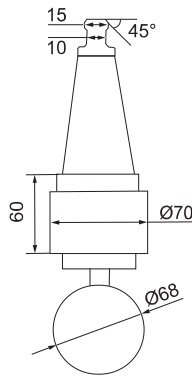

RFS-BT40

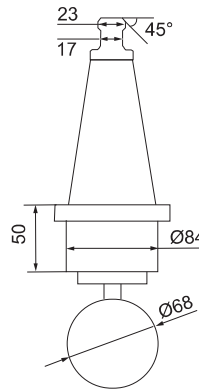

RFS-BT50

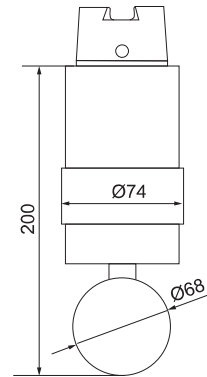

RFS-HSK□□□

RFS-BT系列技术参数

| 型号 | 刀柄型号 | 量程 * | 精度 | 主轴拉力参考范围 | 拉钉角度 ** |
|----------|------|-------------------------|------------------------|--------------|---------|
| RFS-BT30 | BT30 | 0~100kg/cm ² | ±1.6kg/cm ² | 200~500kgf | 45° |
| RFS-BT40 | BT40 | 0~160kg/cm ² | ±2.6kg/cm ² | 500~1100kgf | |
| RFS-BT50 | BT50 | 0~250kg/cm ² | ±4kg/cm ² | 1500~2200kgf | |

RFS-SK系列技术参数

| 型号 | 刀柄型号 | 量程 * | 精度 | 主轴拉力参考范围 |
|----------|-----------|-------------------------|------------------------|--------------|
| RFS-SK30 | SK30/JT30 | 0~100kg/cm ² | ±1.6kg/cm ² | 200~500kgf |
| RFS-SK40 | SK40/JT40 | 0~160kg/cm ² | ±2.6kg/cm ² | 500~1100kgf |
| RFS-SK50 | SK50/JT50 | 0~250kg/cm ² | ±4kg/cm ² | 1500~2200kgf |

RFS-CAT系列技术参数

| 型号 | 刀柄型号 | 量程 * | 精度 | 主轴拉力参考范围 |
|-----------|-------|-------------------------|------------------------|--------------|
| RFS-CAT30 | CAT30 | 0~100kg/cm ² | ±1.6kg/cm ² | 200~500kgf |
| RFS-CAT40 | CAT30 | 0~160kg/cm ² | ±2.6kg/cm ² | 500~1100kgf |
| RFS-CAT50 | CAT30 | 0~250kg/cm ² | ±4kg/cm ² | 1500~2200kgf |

RFS-HSK系列技术参数

| 型号 | 刀柄型号 | 量程* | 精度 | 主轴拉力参考范围 |
|-------------|---------|-------------------------|------------------------|--------------|
| RFS-HSK20A | HSK20A | 0~100kg/cm ² | ±1.6kg/cm ² | 50~100kgf |
| RFS-HSK20C | HSK20C | | | |
| RFS-HSK20E | HSK20E | | | |
| RFS-HSK25A | HSK25A | 0~100kg/cm ² | ±1.6kg/cm ² | 250~500kgf |
| RFS-HSK25C | HSK25C | | | |
| RFS-HSK25E | HSK25E | | | |
| RFS-HSK32A | HSK32A | 0~100kg/cm ² | ±1.6kg/cm ² | 300~600kgf |
| RFS-HSK32B | HSK32B | | | |
| RFS-HSK32C | HSK32C | | | |
| RFS-HSK32D | HSK32D | | | |
| RFS-HSK32E | HSK32E | | | |
| RFS-HSK32F | HSK32F | | | |
| RFS-HSK40A | HSK40A | 0~250kg/cm ² | ±4.0kg/cm ² | 750~1500kgf |
| RFS-HSK40B | HSK40B | | | |
| RFS-HSK40C | HSK40C | | | |
| RFS-HSK40D | HSK40D | | | |
| RFS-HSK40E | HSK40E | | | |
| RFS-HSK40F | HSK40F | | | |
| RFS-HSK50A | HSK50A | 0~350kg/cm ² | ±5.6kg/cm ² | 1000~2000kgf |
| RFS-HSK50B | HSK50B | | | |
| RFS-HSK50C | HSK50C | | | |
| RFS-HSK50D | HSK50D | | | |
| RFS-HSK50E | HSK50E | | | |
| RFS-HSK50F | HSK50F | | | |
| RFS-HSK63A | HSK63A | 0~350kg/cm ² | ±5.6kg/cm ² | 1500~3000kgf |
| RFS-HSK63B | HSK63B | | | |
| RFS-HSK63C | HSK63C | | | |
| RFS-HSK63D | HSK63D | | | |
| RFS-HSK63E | HSK63E | | | |
| RFS-HSK63F | HSK63F | | | |
| RFS-HSK80A | HSK80A | 0~600kg/cm ² | ±9.6kg/cm ² | 2000~4000kgf |
| RFS-HSK80B | HSK80B | | | |
| RFS-HSK80C | HSK80C | | | |
| RFS-HSK80D | HSK80D | | | |
| RFS-HSK80E | HSK80E | | | |
| RFS-HSK80F | HSK80F | | | |
| RFS-HSK100A | HSK100A | 0~600kg/cm ² | ±9.6kg/cm ² | 4000~5500kgf |
| RFS-HSK100B | HSK100B | | | |
| RFS-HSK100C | HSK100C | | | |
| RFS-HSK100D | HSK100D | | | |
| RFS-HSK100E | HSK100E | | | |
| RFS-HSK100F | HSK100F | | | |

* 主轴拉力计的拉力实际值 (kgf) 为表读数×10

** 可定制60°和90°